



## **QUALITY HOT TUB COVERS**



**Hot tub covers made to your specifications!**



# INDEX

	<u>PAGE(S)</u>
Introduction	1
Description of Cover Features	2, 3 & 4
How to measure the corner Radius (3 options)	5, 6 & 7
‘What we call STANDARD’	8
Price Structure	9
Order Form	10



Spaeuro covers are made to the highest specifications in the industry. We are passionate that the materials we use are the best available and the manufacturing process we follow ensures the highest quality for the completed spa cover.

We will not skimp on material quality or cut corners in the manufacturing process to produce a cheaper low quality product.

There are many 'grades' of vinyl available today, not many are designed for outdoor use. Cutting back on the cost of the vinyl is a huge mistake.

We don't promote 'gimmicks' to add value to the covers unless they genuinely add to the performance of the cover.

The spa cover is a critical part of the spa to protect it and save energy costs.

With general care your spa cover will provide your spa with the protection it needs for many years.

The following pages outline a few of the features that make our covers top quality.

We all want to keep our customers happy, and provide them with quality products they can recommend to their friends.

Why would you sell anything else?

### **Delivery Times**

We quote, and achieve, a general delivery time of 4-5 weeks for standard shaped covers. If there are any instances when we require additional approval for design drawings etc we will advise you when we receive the order, this will normally incur a delay in production as the vinyl will not follow the usual route through the factory.

The vinyls are imported from the US and sometimes this incurs delays that are outside our control, we make every effort to reduce any delays.

If you need any help please call us on 01443 437915 or email [spaeurosales@gmail.com](mailto:spaeurosales@gmail.com)



## **Handles**

Our five layers of internal reinforcement add strength where it's needed most. Our hot tub cover handles are made to be extremely strong . They are fully integrated into the spa cover with additional stitching and internal reinforcement making them one of the strongest available on the market.



## **Locking Safety Strap**

Sturdier than the standard hardware, side release fasteners hold up better in extremely cold climates-but, the best thing about this feature is its ease of use. It also locks for safety and includes two keys and screws to mount the hardware.



## **Skirt Design:**

Our spa cover skirts are double stitched into the cover for strength and gusseted to provide the best protection, keeping heat in and dirt out. While the sun beats down on your hot tub cover, extreme heat builds up between the skirt and the outer lip of the spa, and this heat can damage the outer lip of the spa. Our skirt enables this heat to escape, preventing heat damage from occurring while preventing any dirt from entering the hot tub.



## **Zippers:**

The zipper pull is neatly tucked away in its own pocket. This not only protects the zipper, but it is also much more attractive than an exposed zipper and contributes to the finished appearance. We use a true YKK7 heavy duty nylon zipper that is corrosion resistant.





### **Heat Seal Gasket:**

Our insulating gasket seals heat loss where the two halves fold together. When the cover is shut, the two halves seal automatically which is critical to long-term energy savings. Payback on energy savings is typically less than 12 months, according to independent testing.



### **Hinge Design:**

Our Sturdy hinge offers four layers of vinyl, adding extra durability and strength to this high-stress area. Our hinge was put to test when an Igloo Cover was hooked up to an automatic arm, which lifted the cover on and off more than 6000 times with no discernible wear to the hinge.

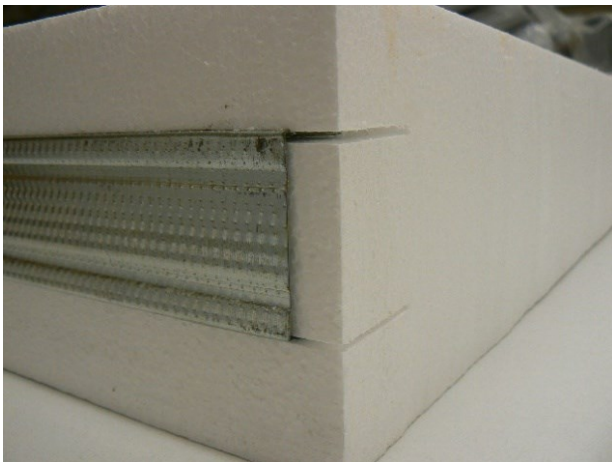

### **Steel Reinforced**

A 'C' channel provides strong support across the centre of the hot tub cover. This non-corrosive steel channel strengthens the centre of the Igloo covers giving extra support in areas that experience extreme weather.



### **Marine Grade Vinyl:**

Our vinyl is treated with mildew and UV inhibitors for overall longevity and year round beauty. We have not gone to the less expensive materials without plasticizers.

Our material still has the flexibility to stretch with the core rather than failing at points of stress where the less expensive vinyl cannot compete. Our vinyl has a negative 20 degree cold crack rating and is tested to 1500UV hours.

## **Igloo Spa Covers**

Igloo Covers' manufacturing process uses 100% CAD driven material cutting machinery. The Vinyl is cut using automated machinery giving Igloo very consistent product quality, lower scrap rates, and efficiencies unique to hot tub cover manufacturing . Igloo Covers technology allows us to manage complexity whether your needs are OEM or aftermarket. Every hot tub cover is bar coded and tracked through the entire manufacturing process to delivery, whether it's end user or distribution. Igloo Covers is able to design and produce covers specific to your requirements including heat stamping logos, silk screening, foam densities, custom colours and heat retention options.

## **Standard Features:**

Igloo Covers exceed safety standards! Igloo Covers are designed to serve as a thermal Insulating locking safety cover for your spa. Our covers were tested by an independent laboratory to comply with ASTM Safety Standards. Our covers are all classified for ASTM Safety on all sizes, densities and models, even swim spas.

## **Highlights of OUR Marine Grade Vinyl:**

- Cold cracking freeze resistant to -30 degrees Celsius
  - Ultra Violet stabilized pigments
    - Oil Stain resistant
    - Mildew resistant
    - Fungus resistant
    - Sulfide stain resistant
  - Resistant to Salt Water staining
- Easily cleaned with soap and water.

## **3 Year Warranty**

We stand behind our product, regarding both materials and workmanship. Based on our historical data, we guarantee that we make an excellent, industry leading product.

## Radius Measuring Option 1 : Cover Radius Calculation Chart

Actual Measurement CM				Radius to Order CM
Bottom Size	between	Top Size		
3	and	6	➡	2.5
6	and	10	➡	5
10	and	14	➡	7.5
14	and	18	➡	10
18	and	22	➡	12.5
22	and	26	➡	15
26	and	29	➡	17.5
29	and	33	➡	20
33	and	37	➡	22.5
37	and	41	➡	25
41	and	45	➡	27.5
45	and	49	➡	30
49	and	53	➡	32.5
53	and	57	➡	35
57	and	61	➡	37.5
61	and	65	➡	40
65	and	69	➡	42.5
69	and	73	➡	45
73	and	77	➡	47.5
77	and	80	➡	50

### EXAMPLE:

Take a measurement between the start and end points of the radius.



My tape reading is 30cm

From Chart my reading is between 29cm and 33cm

29	and	33	➡	<b>20</b>
----	-----	----	---	-----------

**I therefore order 20cm radius**

## **Radius Measuring Option 2: Straight edge and Tape Measure**

### **STEP 1**

Using a straight object (we've used a broom handle) hold the straight line on one edge of the cover. Place the start of your tape measure at the start of the radius and measure to the broom handle.



### **STEP 2**

The measurement you take is the measurement of the Radius. The accuracy of the measurement is not critical, take it to the nearest 2.5cm

This Radius is 20cm





### Radius Measuring Option 3: Transparent Overlay

Using the transparent Overlay provided, simply align the corner radius of the spa cover with the 'best match' radius on the overlay. The nearest match will indicate the corner radius of the cover.

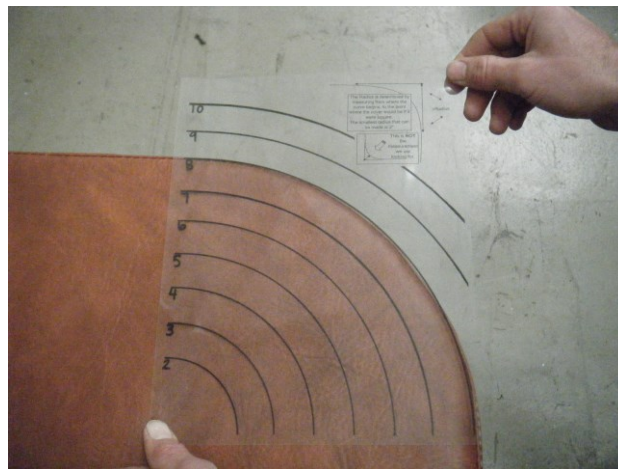

The Radius of the cover shown in this example is 20cm





## **What we consider STANDARD!**

If we receive an order that has incomplete detailed specifications or the customer has selected 'STANDARD', we will complete the order in the following way.

<b><u>FEATURE</u></b>	<b><u>STANDARD SELECTION</u></b>
CORNER RADIUS	20cm
SKIRT LENGTH	10cm
STRAP POSITION	C
STRAP LENGTH	20cm
STRAP INSET	RADIUS + 5cm
THICKNESS	12.5cm to 7.5cm

If you **DO NOT** want these details entered you **MUST** complete the detail of the feature.